

CABINET ASSEMBLY INSTRUCTIONS – WALL CABINETS

STEP 1: Disconnect door from frame in order to prevent damages during assembly and installation.



STEP 2: Locate the side panels.
Insert side panel into the groove in the frame.



STEP 3: Secure the side to the frame by using a staple gun (3/4" Deep by 1/4" Wide staples are recommended). Staple the side every 6".



STEP 4: For increased durability use a hot glue gun to glue the joint of the frame and the side panels together. Make sure to leave a thin, even layer and to wipe off the excess glue after it is dry.



STEP 5: Repeat Steps 3 and 4 with the other side panel.



STEP 6: Locate the identical top and bottom panels.
Insert each of them in the grooves of the side panel. Make sure the notch on the side of the panels faces the frame.



STEP 7: Do NOT staple the top and bottom panels from the inside. Staples and glue will be used from the outside (see next step).



STEP 8: After the panels are inserted in the grooves. Secure them using staples every 4-6". Repeat this step with the other panel.



CABINET ASSEMBLY INSTRUCTIONS – WALL CABINETS

STEP 9: Add a layer of hot glue. Repeat this step with the other panel.



STEP 10: Locate both shelves (left) and the back panel (right).



STEP 11: Slide the back panel in the grooves.



STEP 12: Make sure the back panel is inserted properly.



STEP 13: Locate the shelf holders (left) and the screws to the back (right).

Use four screws to secure the back panel to the frame (in each pre-drilled hole).



STEP 14: Using a regular Philips Head Screwdriver, secure all four screws.



STEP 15: Use two staples (either 3/4" or 1" staples) to secure the side of the cabinet.

Do not staple more than 1/2" below the top or you will "miss" the back plywood piece.



STEP 16: Repeat this process with each side (four in total). Congratulations! Your cabinet is now ready. Remember to re-install the doors and shelves after installation in order to avoid damages.

CABINET ASSEMBLY INSTRUCTIONS – BASE CABINETS

STEP 1: Remove the door from frame. It is best to re-install the door after the installation of all cabinets. Otherwise, doors might be damaged during the assembly and installation.



STEP 4: If you are using hot glue (optional, but recommended) make sure to apply a thin layer of glue over the connection of the side panel and the frame (from the inside of the cabinet as shown in the photo).



STEP 2: Locate the two top support pieces.



STEP 5: Repeat Steps 3 and 4 with the other side panel.



STEP 3: Secure the side panel to the frame using 1/4" wide by 3/4" deep staples every 6".



STEP 6: Insert the bottom panel through the grooves. Staple every 4-6" and apply hot glue.



CABINET ASSEMBLY INSTRUCTIONS – BASE CABINETS

STEP 7: Slide in the back panel starting from the bottom moving toward the top.



STEP 8: Make sure both panels are aligned. Otherwise, it will be very difficult to level the plywood for the countertop.



STEP 9: Staple the bottom of the back panel to secure it to the frame (use 3/4" staples every 4-6").



STEP 10: Staple the side panel to the cabinet for extra reinforcement. Use either 3/4" or 1" staples. Use two staples on each side of the cabinet.



STEP 11: Locate the toe kick plate.



STEP 12: Staple it to the bottom of the cabinet using 3/4" staples every 4-6".

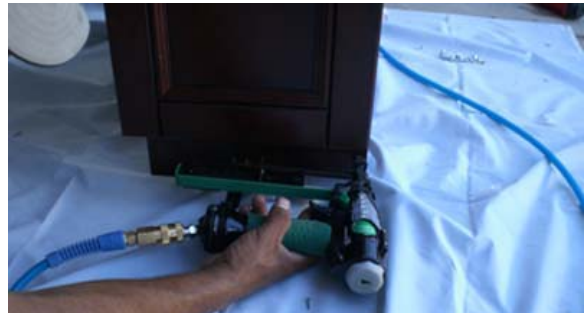

STEP 13: Congratulations! Your cabinet is now ready.



CABINET ASSEMBLY INSTRUCTIONS – DRAWER BASE

STEP 1: Locate all of the following parts:

- Bottom panel
- Two side panels (long ones)
- Back panel
- Front panel (drawer face)



STEP 2: Connect the side panel to front panel.
Optional: Use carpenter's glue to glue connections.



STEP 3: Connect the other side panel.



STEP 4: Slide in the bottom panel to the groove on the bottom.



STEP 5: Make sure bottom panel is aligned with the back of the side panels.



STEP 6: Connect the back panel. Make sure that the notch and the pre-drilled holes are facing down.



CABINET ASSEMBLY INSTRUCTIONS – DRAWER BASE

STEP 7: Locate the pre-drilled holes on the side of the cabinet.
Connect the drawer guides using a drill or a screwdriver.



STEP 10: Insert the pins in the holes.
Note: The round plate under the pin can be used for easy adjustments.
Congratulations! Your drawer is now ready.



STEP 8: Make sure the front of the drawer guides align with the back side of the face frame.
In the photo the left guide is installed correctly. The right one is NOT CORRECT because the front of the guide passes the back side of the face frame.



STEP 9:
Slide drawer until the pins are in the holes.



CABINET ASSEMBLY INSTRUCTIONS – BASE END CABINETS

STEP 1: Locate the two face frames and doors



STEP 2: Remove both doors from the frame. Do NOT remove the drawers face and they are decorative (fake).



STEP 3: Connect the two face frame together using the supplied 3 angled brackets.



STEP 4: Insert the bottom panel in the slots.



STEP 5: Connect the side panel to the back panel. Secure the panels using staples between the side panel the and bottom panel.



STEP 6: Repeat the previous step with the other side panel.



CABINET ASSEMBLY INSTRUCTIONS – BASE END CABINETS

STEP 7: Slide in the back panel.



STEP 10: Secure the toe-kick using staples (two in each side).



STEP 8: Reinforce the cabinet structure using staples every 6" between the side panels and the back panel.



STEP 11: Re-connect the two front doors and install the shelf.

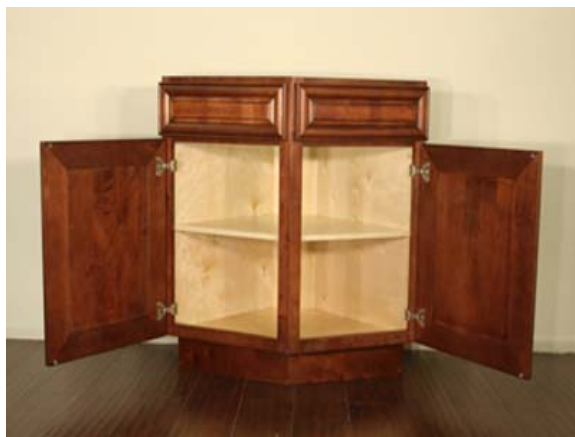

STEP 9: Locate the two toe-kick pieces and join them together using staples as shown in the photo.



CABINET ASSEMBLY INSTRUCTIONS – CORNER BASE DIAGONAL

STEP 1: Locate the face frame and the front door



STEP 2: Remove the door from the frame



STEP 3: - Locate the bottom shelf the the Black rotating hinge. Connect the Black spinning hinge to the bottom shelf using four screws. Make sure the groove of the bottom shelf (at the bottom of this photo) will face up.

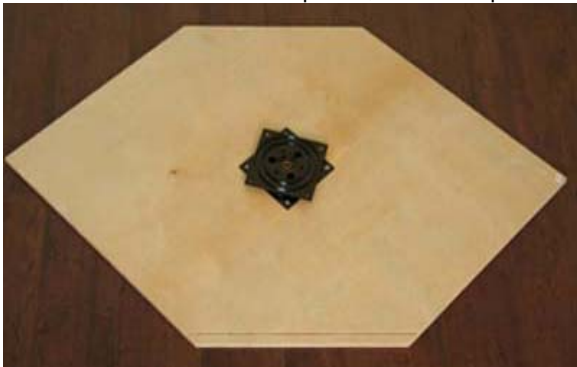

STEP 4: Locate the bottom spinning tray (the one with the three pre-drilled holes on the bottom)



STEP 5: Connect the bottom shelf to the spinning tray using three screws from the back (the bottom) of the bottom shelf.



STEP 6: Close up on the back (bottom) of the bottom shelf.



STEP 7: This is how the spinning tray should look like when connected to the bottom shelf.



STEP 8: Connect the face frame to the front site panel using two of the supplied angled brackets.



CABINET ASSEMBLY INSTRUCTIONS – CORNER BASE DIAGONAL

STEP 9: Connect the other front side panel using two additional angled brackets.



STEP 10: Insert the bottom shelf with the spinning tray in the pre-drilled slots on the front side panels and the face frame.



STEP 11: Connect the back side panel to the front side panel using the supplied 90 degree bracket.



STEP 12: Secure the back side panel to the bottom shelf using three screws in the pre-drilled holes. Do not secure the screw all the way in this point to allow some flexibility until all the panels will be connected properly.



STEP 13: Repeat the last two steps with the other side.

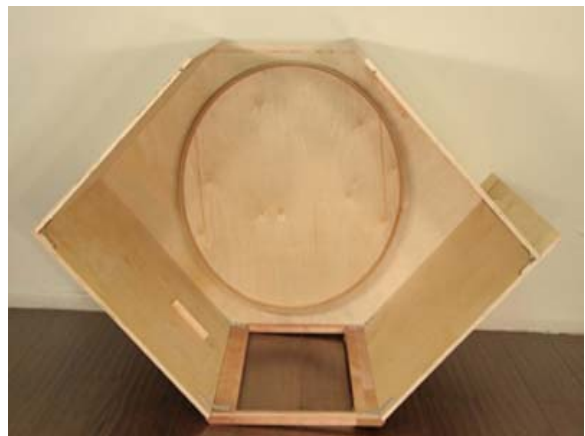

STEP 14: Slide in the back panel in the pre-drilled slots.



CABINET ASSEMBLY INSTRUCTIONS – CORNER BASE DIAGONAL

STEP 15: Connect the top support piece using three screws to the back panel and 2 screws on each side to the back side panels.



STEP 16: Locate the top spinning tray, the top Black spinning hinge and the top shelf. (the top spinning tray has four pre-drilled holes).



STEP 17: Connect the top black spinning hinge to the top shelf using four screws. Make sure the pre-drilled holes on the top shelf are facing up



STEP 18: Connect the top black spinning hinge to the back of the top spinning tray using four screws in the pre-drilled holes.

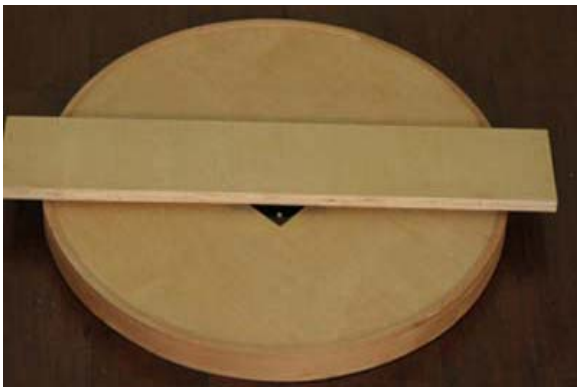

STEP 19: Place the top shelf with the spinning tray on top of the two support blocks on the back side panels. Secure using two screws on each side.



STEP 20: Connect the toe-kick piece on the bottom of the cabinet using two screws on each side.



STEP 21: Connect the door to the face frame. Your cabinet is now ready!

